

DRC
PZ23-120000-17
11/20/2024

STAIR No. # 1	
EGRESS CAPACITY FACTOR: 0.3	
147 OCCP.	44" STAIR

STAIR No. # 1 - DOOR	
EGRESS CAPACITY FACTOR: 0.2	
170 OCCP.	34" OPENING

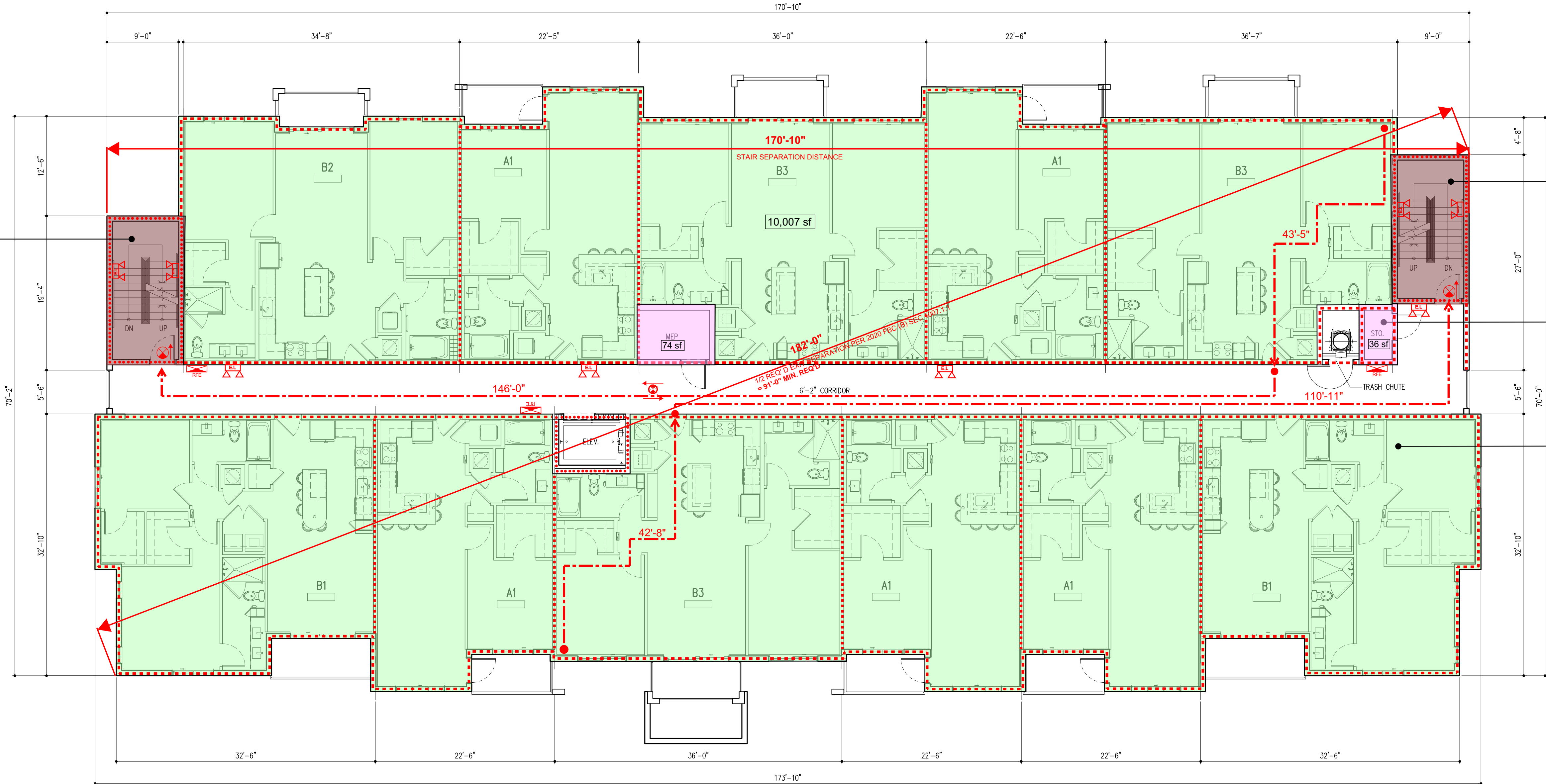

STAIR No. # 2	
EGRESS CAPACITY FACTOR: 0.3	
147 OCCP.	44" STAIR

STAIR No. # 2 - DOOR	
EGRESS CAPACITY FACTOR: 0.2	
170 OCCP.	34" OPENING

STORAGE	
STO 36 SF @ 300 SF = 1 OCCUP.	
MEP 74 SF @ 300 SF = 1 OCCUP.	
2 OCCUP.	

R-2 OCCUPANCY	
NEW APARTMENTS 10,007 SF @ 200 SF PER OCCUP.	
= 50 OCCUP.	

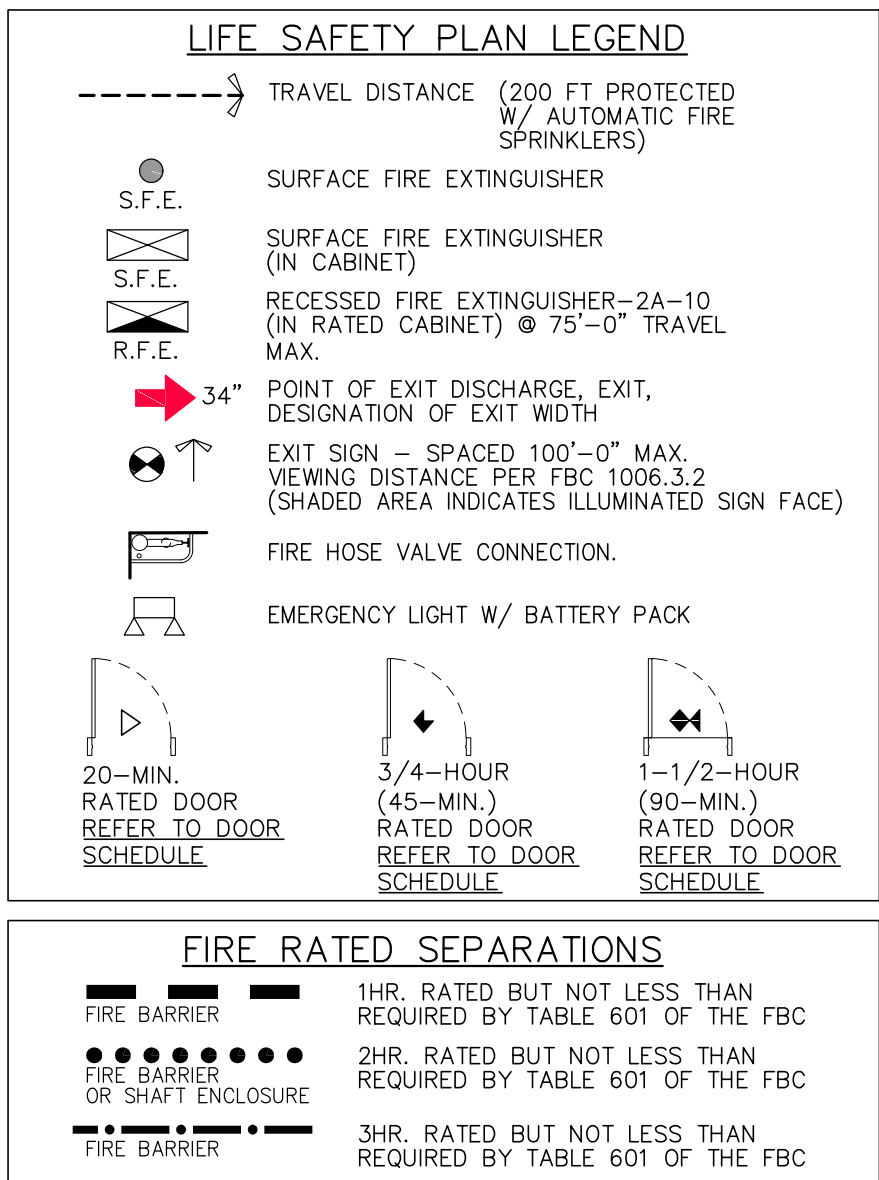

NOTE:
FIRE RATINGS SHOWN ON LIFE SAFETY PLANS ARE FIRE SEPARATION REQUIREMENTS AS PER THE FBC AND NFPA 101. REFER TO FBC TABLE 601, "FIRE-RESISTANCE RATING REQUIREMENTS FOR BUILDING ELEMENTS" FOR FIRE RATING REQUIREMENTS OF STRUCTURAL ELEMENTS. REFER TO STRUCTURAL DRAWINGS FOR LOCATION OF ALL STRUCTURAL ELEMENTS.

ACCESSIBLE MEANS OF EGRESS

- THERE WILL BE A MAXIMUM OF 1/2" CHANGE IN ELEVATION AT EXIT DOOR THRESHOLDS.
- ALL WALKWAYS LEADING TO PUBLIC WAY SHALL HAVE A SLOPE NOT GREATER THAN 1:20
- THE FLOOR ON EACH SIDE OF DOORS IN A MEAN OF EGRESS SHALL BE LEVEL AT LEAST WITHIN THE REQUIRED MANEUVERING CLEARANCES AT EACH SIDE OF THE DOOR.

BUILDING SIGNAGE

XXXXX PROVIDE RESIDENTIAL BUILDING ADDRESS SIGN(S) IN CONTRASTING COLOR, 10" MIN. IN HEIGHT, REFER TO LS-LIFE SAFETY FLOOR PLAN(S) (THIS SHEET) AND BUILDING ELEVATION SERIES '3' SHEETS FOR LOCATION AND FURTHER REFERENCE

XXXXX PROVIDE RESIDENTIAL UNIT NUMBER SIGN(S) WITH MIN 1/2" LETTERS PROVIDED SIGN ADJACENT TO EACH UNIT ENTRY DOOR @ 72" A.F.F

PROVIDE PLACARD FOR LIGHT FRAME ROOF, AS PER FLORIDA STATE RULE 69A-60.0081.FOR REQUIRED FIREFIGHTER WARNING SIGNS.

BUILDING PUBLIC SAFETY RADIO ENHANCEMENT SYSTEMS
SHALL COMPLY WITH NFPA 72 (2013ED) 24.5.2 AND 14.4.10 NFPA (2015ED) 11.10, **POMPAÑO BEACH** FIRE DEPT. REQUIREMENTS AND MUST BE TIED TO FACP.

LEVEL 2
11 UNITS

LIFE SAFETY - BLDG TYPE II
5 STORY/54 DU'S SCALE: 1/8" = 1'-0"

OAKS @ PALM AIRE
FOR: MORGUARD
LOCATED AT: POMPAÑO BEACH, FLORIDA

Jose Saumell
ARCHITECT

STATE OF FLORIDA
REGISTERED ARCHITECT
JOSE I. SAUMELL
AR0013085

MSA ARCHITECTS, INC.
A40000895
8940 SW 74th COURT
SUITE 1513
MIAMI, FLORIDA 33156
(305) 273-9911

MSA ARCHITECTS
ARCHITECTURE & PLANNING

ARCHITECTS BUILDING CODE STATEMENT/ TO THE BEST OF THE ARCHITECT'S KNOWLEDGE THE PLANS AND SPECIFICATIONS COMPLY WITH THE FLORIDA BUILDING CODE SEVENTH EDITION (2022) AND THE APPLICABLE FIRE SAFETY STANDARDS AS DETERMINED BY THE LOCAL AUTHORITY AND CHARGED WITH ENFORCEMENT. THE ARCHITECT'S LIABILITY IS LIMITED TO THE DESIGN AND CONSTRUCTION OF THE PROJECT AND DOES NOT INCLUDE THE LIABILITY OF THE ARCHITECT FOR THE ACTIONS OF OTHER PROFESSIONALS OR THE ACTIONS OF THE LOCAL AUTHORITY AND CHARGED WITH ENFORCEMENT. THE ARCHITECT'S LIABILITY IS LIMITED TO THE DESIGN AND CONSTRUCTION OF THE PROJECT AND DOES NOT INCLUDE THE LIABILITY OF THE ARCHITECT FOR THE ACTIONS OF OTHER PROFESSIONALS OR THE ACTIONS OF THE LOCAL AUTHORITY AND CHARGED WITH ENFORCEMENT.

DRAWN
CONTRACT DATE 10/12/22
SCALE AS SHOWN
JOB NO. 2181.PRJ
SHEET TITLE:
BUILDING TYPE II
SHEET NUMBER:
LS-A-2.2.2